

# EASY TRAK INSTALLATION SHEET

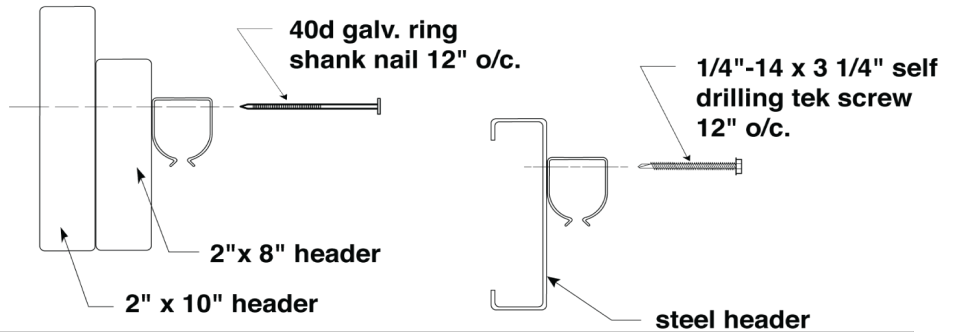
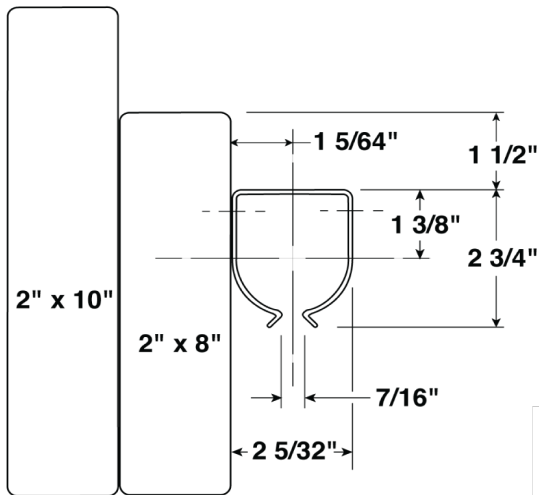

(300 lbs. per trolley w/ roller bearings)

Fasten Easy-Trak to an adequate header that will support door (s) weight.  
For securing trak to a wooden header a 40d, 5 1/2" galv. ring shank nail  
is required every 12" o/c. For smooth door operation, trak must be mounted straight!

**Specifications:**  
Loading 225 lbs. per trolley  
Loading 450 lbs. per door leaf

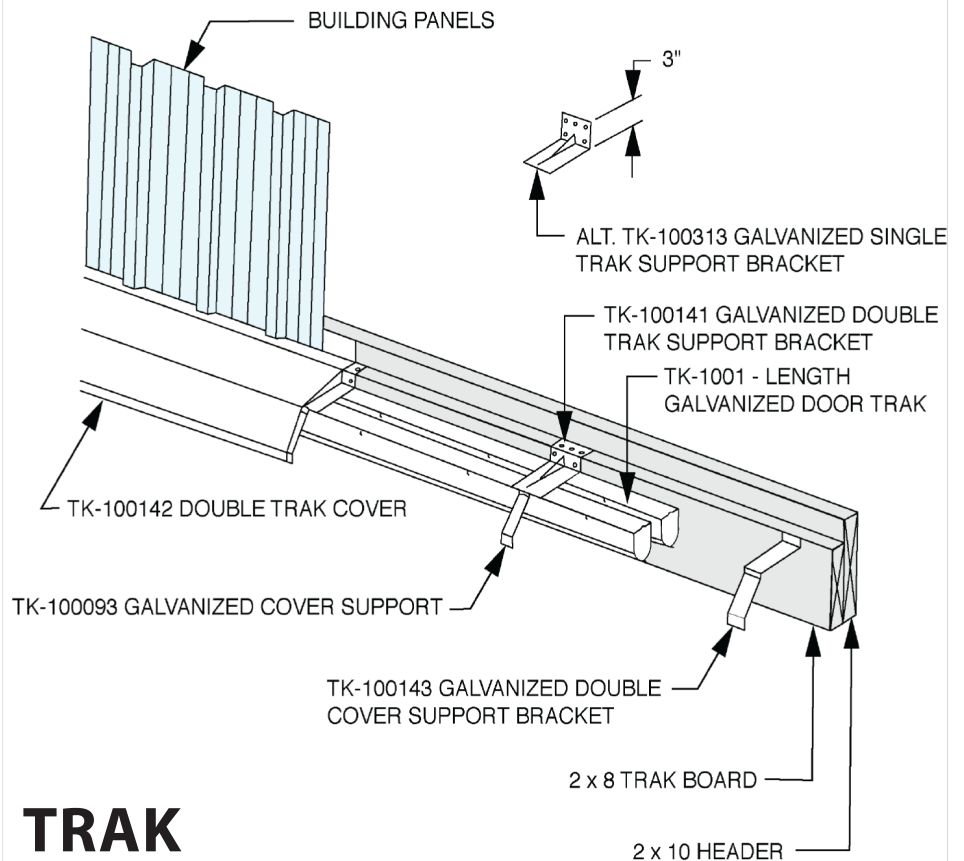

## EASY TRAK DOUBLE-TRAK SYSTEM

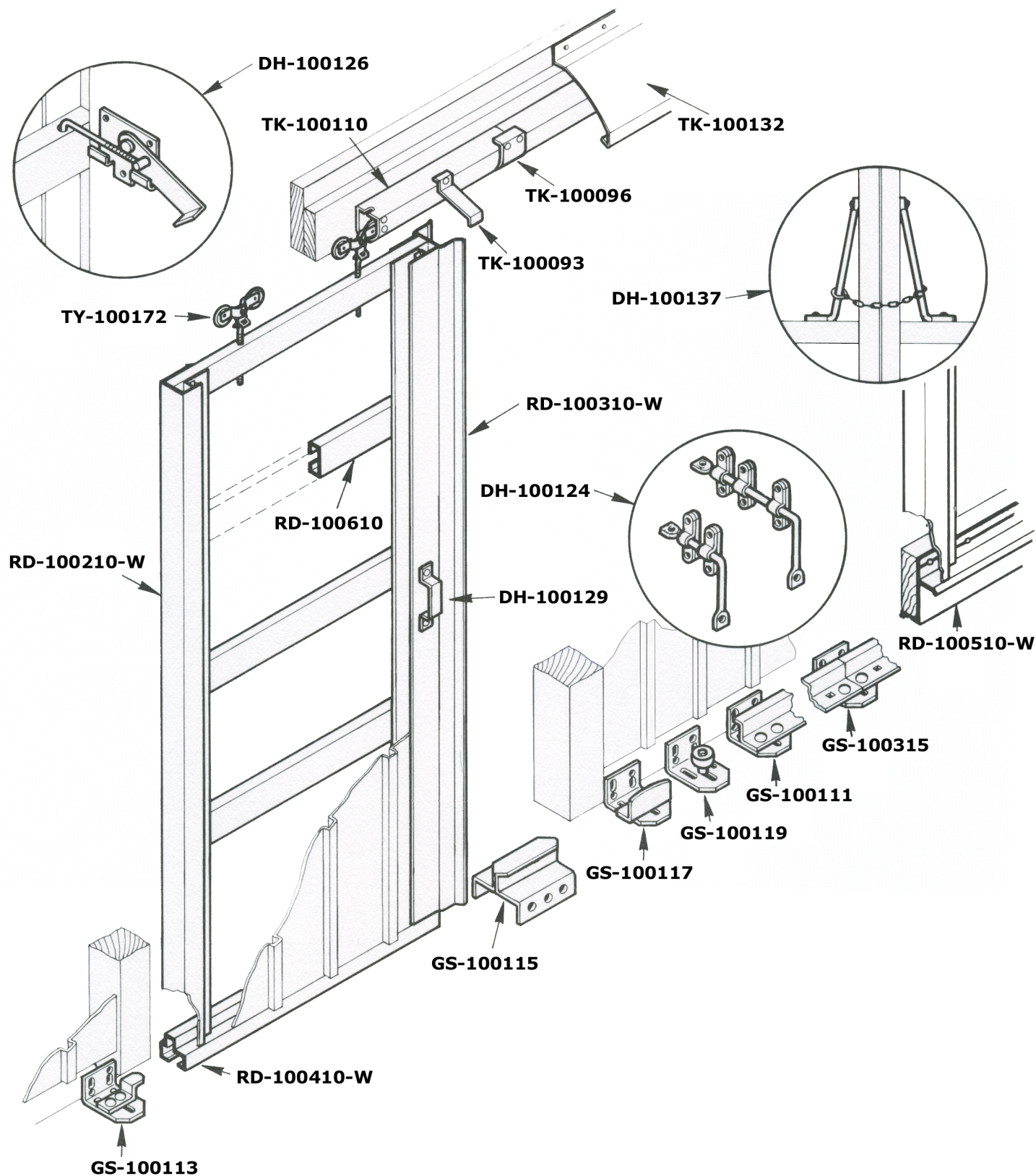

# EASY TRAK HARVARD DOOR

Layout door frame members on a smooth and level surface for assembling of door panel (s).

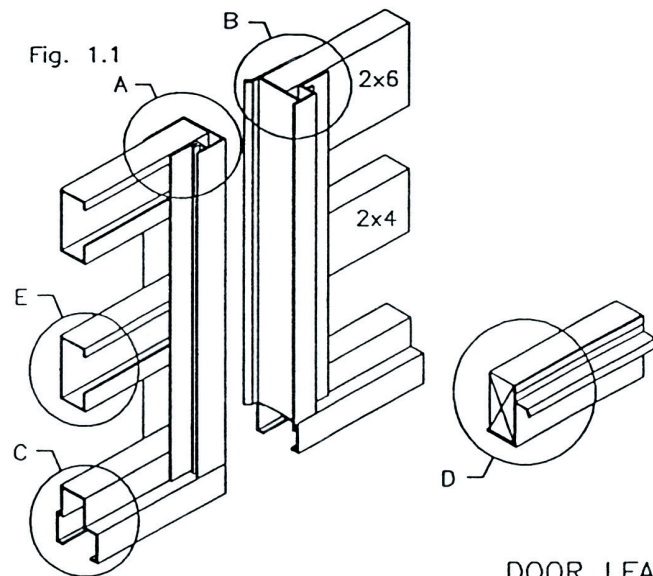

- A. Vertical Rail RD-1002 two required per single door and three required per double door systems.
- B. Vertical Rail with H closure RD-1003 one required only on double door systems.
- C. Bottom Rail RD-1004 one required per door leaf.
- D. Bottom Rail RD-1005 per door system with wooden bottom horizontal member.
- E. Galvanized Steel Girt RD-1006. See girt table for required quantity and spacing. Note! If steel girts are not being used, we recommend a 2x6 for top horizontal member and 2x4's for intermediate door girts.

DOOR LEAF WIDTH

D O O R  L E A F  H E I G H T		6'	7'	8'	9'	10'	12'	14'	16'	18'	20'
	8'	2 48"	2 48"	2 48"	2 48"	2 48"	3 32"	3 32"	3 32"	3 32"	4 24"
	10'	3 40"	3 40"	3 40"	3 40"	3 40"	3 40"	3 40"	4 30"	4 30"	5 24"
	12'	4 36"	4 36"	4 36"	4 36"	4 36"	4 36"	4 36"	5 29"	5 29"	6 24"
	14'	4 42"	4 42"	4 42"	4 42"	4 42"	4 42"	4 42"	5 34"	6 28"	7 24"
	16'	5 38"	5 38"	5 38"	5 38"	5 38"	5 38"	5 38"	6 32"	7 27"	8 24"

Table 1.1

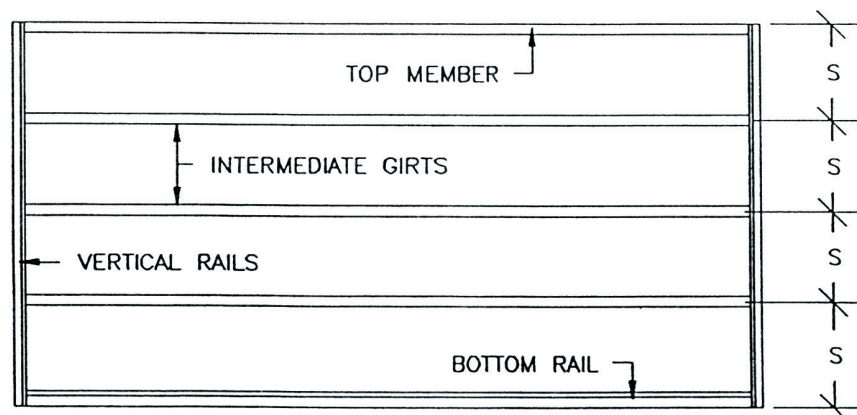

Fig. 1.2

The same part RD-1006 ( 3" X 1 1/2" galvanized steel girts ) are used as the top horizontal member and intermediate door girts.



# EASY TRAK ACCESSORIES

To prepare door frame for fastening, top horizontal member should be drilled at this time for trolley holes. Locate trolley hole dimensions from chart and illustration shown below. Drill four 17/32" diameter holes thru both flanges of steel member.

Door Leaf Width	6'	7'	8'	9'	10'	11'	12'	14'	16'	18'	20'
Dimension 'T'	1'	1'	1'	1'	1'	1'	2'	2'	2'	2'	2'

Table 2.1

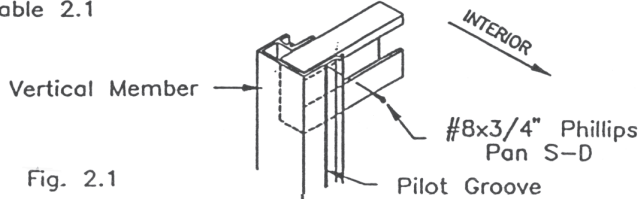

Fig. 2.1

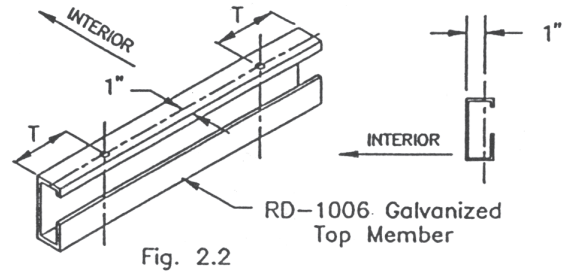

Fig. 2.2

The door frame is now ready to be fastened. The interior of door frame should be secured first.

With the top, intermediate members and bottom rail be properly fitted and spaced in the vertical rails fasten the top and bottom members at each of the four corners using one #8x3/4" phillips self-drilling screw. All screws should be located in the pilot groove of the extruded vertical rails as shown in the next illustration.

After squaring, by measure diagonal across corners, fasten the members with a second screw at each of the four corners.

Turn the door frame over, to the exterior side. Recheck for squareness and repeat the same fastening procedure as done on interior side of door.

Fasten all intermediate horizontal girts with two #8x3/4" self-drilling phillips pan screws per each side of door frame.

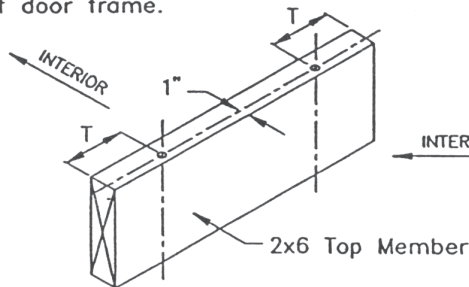

Fig. 2.3

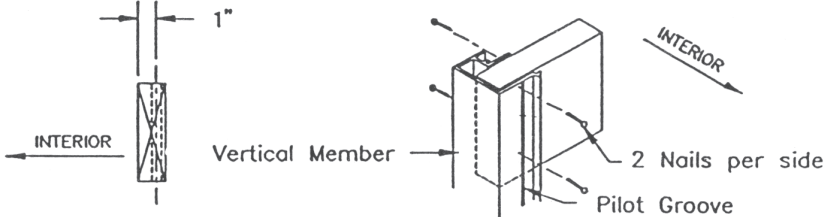

Fig. 2.4

Note! If installing wooden horizontal members in lieu of steel girts, follow the same trolley location and girt spacing as previously indicated. Fastening procedure is identical to steel girts, with the exception of nails are being used. It is recommended that pre-drilling of vertical rails be required before nailing.

Install trolleys on top horizontal member and adjust the washer welded nut on the pendant bolt until there is approximately 1" between the trolley bolt head and top of horizontal member.

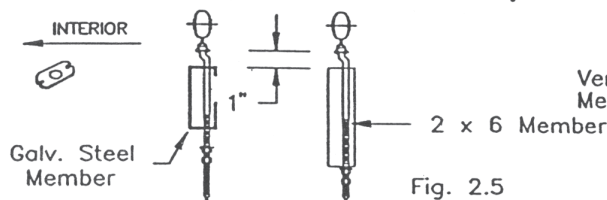

Fig. 2.5

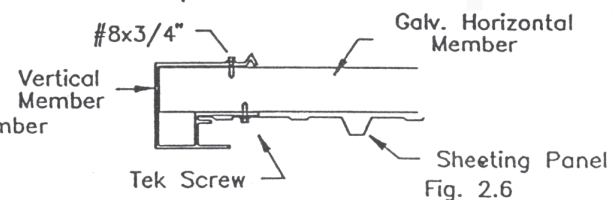

Fig. 2.6

After hanging door(s) and adjusting to required height, fasten 2 self-drilling screws through the washer, welded nut into the top horizontal member. If 2x6 member is used fasten with 2 nails. Adjust the offset pendant bolt so door(s) hangs flush against jams and header. Tighten the jamb nut on the offset pendant bolts to lock trolleys in correct position for smooth door operation.

Apply sheeting panels to door frame per manufacturer's recommendations. The vertical rails are extruded with built-in flashing.

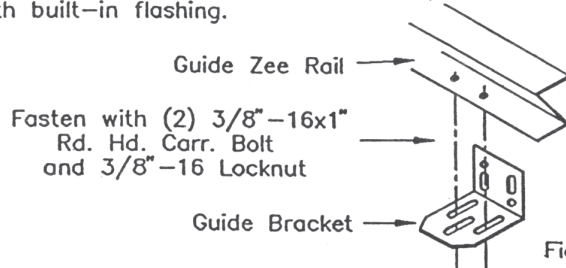

Fig. 2.7

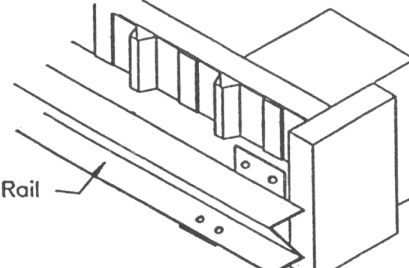

Fig. 2.8

Install continuous guide system flush with jamb opening and make adjustments so door rolls smoothly over guide. Note! Continuous guide length should be 60% of door leaf.